

# Stucco and Plaster

Section: 09200

## Inside Corner Control Joint

Product Number	Ground	Dimensions/Descriptions	Pieces Per Box
<b>2050IC</b>	1/2" (13 mm)	Inside corner control joint.	35
<b>2058IC</b>	5/8" (16 mm)		35
<b>2075IC</b>	3/4" (19 mm)		30
<b>2078IC</b>	7/8" (22 mm)		30

10' (3 m) Lengths

### Application:

Plastic Components' Inside Corner Control Joint relieves stress and cracking caused by expansion and contraction in the inside angles of walls and ceilings.

### Specification:

Inside Corner Control Joint will be Plastic Components, Inc. #\_\_\_\_\_. All exterior accessories shall conform to ASTM standards D1784, C1063 and D4216. All products shall be third party tested to meet ASTM standard D4216 and be Canadian Code Compliant. They shall be used where specified by the architect and installed per industry standards.

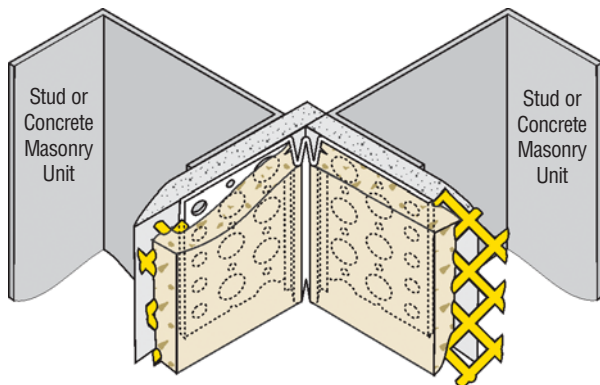
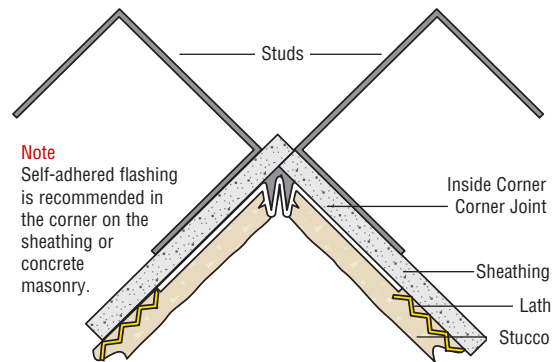

*All butt joints, intersections and ends shall be caulked at the time of installation using an elastomeric sealant, such as Plastic Components' Ultra-Tech™ (PC-ULTW).*