



DESCRIPTION

Available in .25" (6 mm) and .40" (10 mm) thicknesses, Plastic Components' **ULTRA DRAIN MAT™** is a drainage and ventilation system specifically designed for use with most exterior cladding systems.

When building exterior walls with stone, stucco, brick cedar or fiber cement siding, it is important to use an effective rainscreen system that provides drainage and ventilation. Without this protection, moisture finds its way into the wall systems via cracked mortar joints, gaps or cracks in the surface of the material. Natural absorption of the edges of wood or fiber cement board should also be considered. Once moisture penetrates the outer wall surface it becomes trapped in the wall system. Without any way of escaping, the trapped moisture creates a perfect environment for toxic mold growth and possible structural failure.

BENEFITS

- 95% open design creates a continuous capillary break and channel for moisture to drain – also accelerates drying of the exterior cladding
- Durable polymer material resists most known corrosive chemicals – does not provide a food source for mold or mildew
- Minimizes staining, peeling and blistering of exterior finishes
- Made from recycled materials qualifying for LEED credits
- Quick, simple installation – Easier and more cost-effective than traditional furring strip methods.
- 2-ply design features backer fabric that improves the tensile and compressive strength properties of the rainscreen – also deflects mortar when used with stucco or masonry veneer siding
- Integrated insect screen

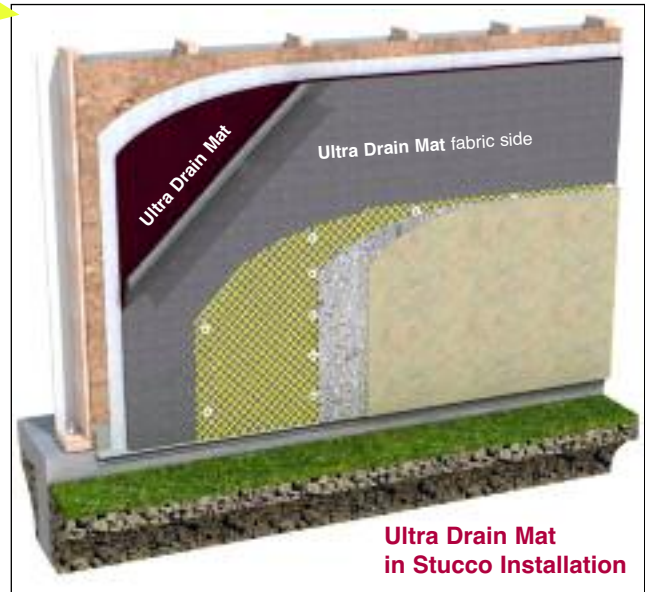

Ultra Drain Mat in Stucco Installation

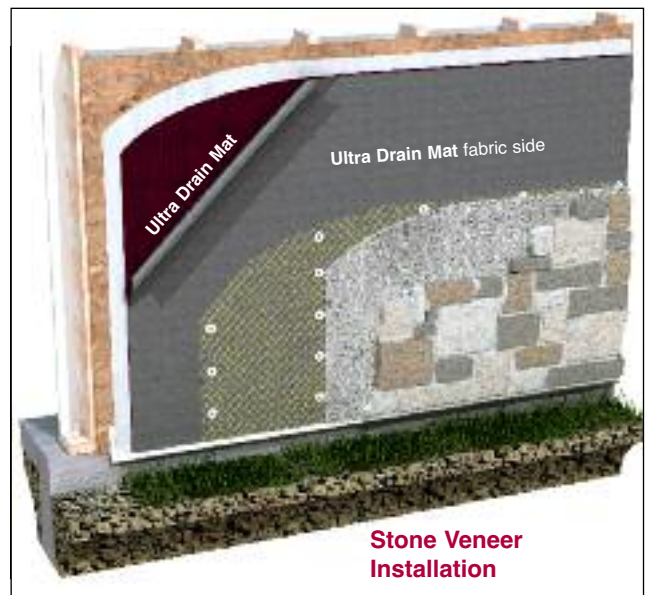

Stone Veneer Installation



.40" (10 mm) Ultra Drain Mat

INSTALLATION INSTRUCTIONS

- Apply weather-resistant barrier over sidewall sheathing
Note: some regions may require two layers of weather-resistant barrier. Check local codes for more information.
- Install Ultra Drain Mat after windows and doors have been properly installed and flashed. Starting at the base of the wall, unroll the Ultra Drain Mat from right to left with the 4" fabric flap at the bottom, the three-dimensional (red) polymer matrix against the weather-resistant barrier and the fabric facing the exterior of the building. Staple or nail every 3 square feet.
- On the first (bottom course) ONLY, unfold the 4" fabric flap and tuck it between the (red) polymer matrix and the weather-resistant barrier to create an insect screen.
- On intermediate courses, butt red polymer fabric together tightly without overlapping. Pull 4" fabric flap over previous course, shingle style, and staple.
- On top course, invert the roll and unroll left to right with the 4" fabric flap at top. Unfold the fabric flap and tuck it between the (red) matrix and the weather-resistant barrier to create an insect screen.
- Apply siding over Ultra Drain Mat using manufacturer's recommended fasteners and spacing.



ULTRA DRAIN MAT™

PLASTIC **PC** COMPONENTS *inc.*

PHYSICAL DATA

**.25" (6 mm)
Ultra Drain Mat**

**.40" (10 mm)
Ultra Drain Mat**

Core Material	Polypropylene (cornrow)	Polypropylene (waffle)
Thickness	0.25 in. (6 mm)	.40 in. (10 mm)
Roll Length	61.5 ft. (18.75 m)	40 ft. (12.19 m)
Roll Width	39 in. (99.06 cm)	39 in. (99.06 cm)
Roll Weight	14 lbs. (6.35 kg)	16 lbs. (7.26 kg)
Coverage Area	200 sq. ft. (18.58 m ²)	130 sq. ft. (12.08 m ²)

TECHNICAL DATA

**.25" (6 mm)
Ultra Drain Mat**

**.40" (10 mm)
Ultra Drain Mat**

Mortar Deflection & Ventilation Material Thickness	.25 in. (6 mm)	.40 in. (10 mm)
Density / Specific Gravity (ASTM D 792, Method A)	0.901 g/cm ³	0.903 g/cm ³
Porosity (open space) ECTCTASC00197)	93.8 %	95.3 %
Mass / Unit Area (composite) (ASTM D 5261 / D 6566)	11.25 oz/sq.yd	15.10 oz/sq.yd
Hydraulic Transmissivity (ASTM D 4716)	3.70 gpm/ft width	7.01 gpm/ft width
Air Transmissivity (ASTM D 4716, mod)	15.8 cu.ft/min/ft width	54.5 cu.ft/min/ft width
Flame Spread & Smoke Index (ASTM E 84)	Class A Fire Rated	Class A Fire Rated

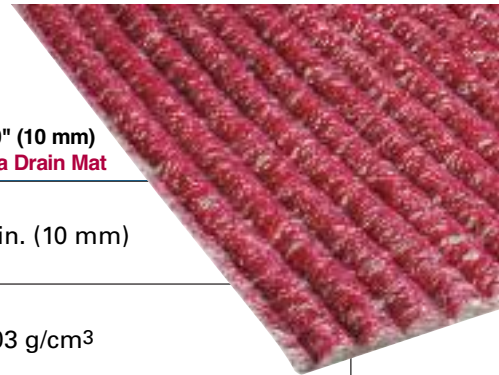

ULTRA DRAIN MAT

Cat #	Thickness	Description	Roll Dimens	Rolls/pallet
UDM-25	0.25" (6 mm)	Drainage mat, ventilation system.	39" x 61.5' (99 cm x 18.75 M)	18
UDM-40	0.40" (10 mm)	Made of durable 2-ply polymer. Fabric-backed.	39" x 40' (99 cm x 12.2 M)	18

UDM-40 .40 inch (10 mm) product meets the physical requirements of Section 9.27.2.2, Item 1b of the 2005 National Building Code of Canada and 2006 British Columbia Building Code.

