

REVISION HISTORY			
REV	DESCRIPTION	DATE	APPROVED

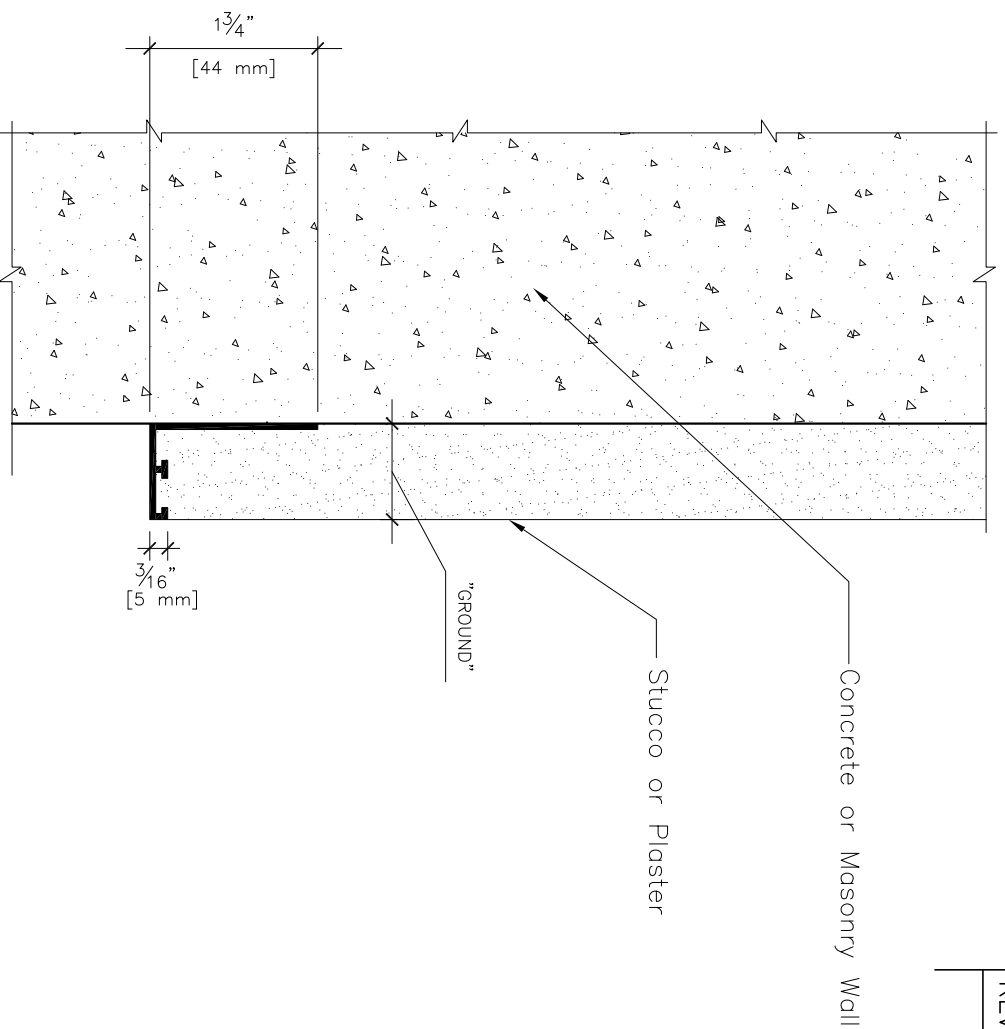

Product Submittal	Product Number	Dimension "GROUND"
	1100	1" [25 mm]
	1125	1 1/4" [32 mm]
	1150	1 1/2" [38 mm]
	1200	2" [51 mm]

## **"T" Bar Casing Bead for Stucco and Plaster**

SCALE: 6" = 1'-0"

### NOTES:

1. Typical installation shown.
2. Actual installation shall meet all local building codes and ASTM standards.
3. All butt joints, intersections, ends and corners shall be caulked at the time of installation using an elastomeric sealant, such as Plastic Components "Ultra Tech" (PC-ULTW).

	NAME	DATE	PLASTIC COMPONENTS, Inc.	
DRAWN	JKW	12/2/2011	9051 NW 97th Terrace ~ Miami, FL 33178	
CHECKED			800-327-7077 ~ www.plasticcomponents.com	
ENG APPR			TITLE	
MGR APPR			"T" Bar Casing Bead	
UNLESS OTHERWISE SPECIFIED DIMENSIONS ARE IN INCHES ANGLES ±X.X°			SIZE DWG NO	REV
2 PL ±X.XX 3 PL ±X.XXX			A "T" Bar Casing Bead	
			FILENAME:T-Bar Casing Bead - Stucco.dwg	
			SCALE:      WEIGHT:      SHEET 1 OF 1	