

REVISION HISTORY			
REV	DESCRIPTION	DATE	APPROVED

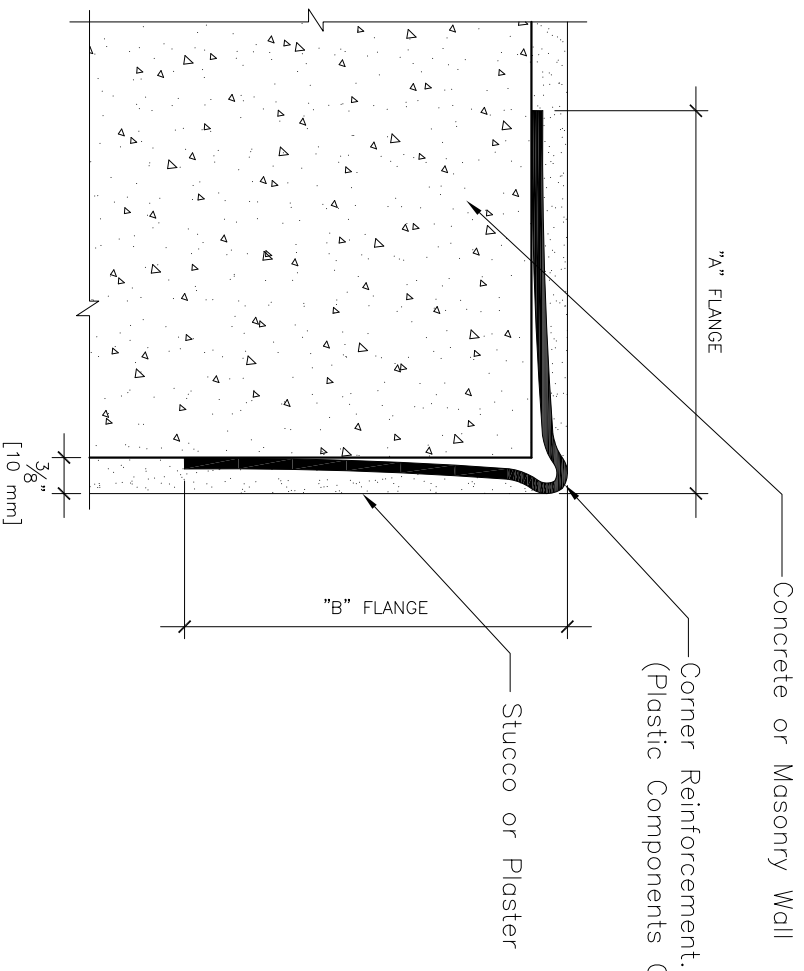

Product Number BN1A is not shown in the drawing.

Product Submittal	Product Number	Dimension "A" Flange	Dimension "B" Flange
	1A	2 1/2" [64 mm]	2 1/2" [64 mm]
	1B	1 1/2" [38 mm]	1 1/2" [38 mm]
	2	2 3/4" [70 mm]	2 3/4" [70 mm]
	3	2 1/2" [64 mm]	1 1/2" [38 mm]
	1A4	4" [102 mm]	4" [102 mm]
	1A135	2 1/2" [64 mm] Angled Flange	2 1/2" [64 mm] Angled Flange
	BN1A	2 1/2" [64 mm] Bullnose Flange	2 1/2" [64 mm] Bullnose Flange

Corner Bead for Stucco and Plaster

SCALE: 6" = 1'-0"

NOTES:

1. Typical installation shown.
2. Actual installation shall meet all local building codes and ASTM standards.
3. All butt joints, intersections, ends and corners shall be caulked at the time of installation using an elastomeric sealant, such as Plastic Components "Ultra Tech" (PC-ULTW).

NAME	DATE	PLASTIC COMPONENTS, Inc.	
DRAWN JKW	1/3/2012	9051 NW 97th Terrace ~ Miami, FL 33178 800-327-7077 ~ www.plasticcomponents.com	
CHECKED		TITLE Corner Bead for Stucco and Plaster Over Concrete or Masonry CMU	
ENG APPR		SIZE DWG NO	REV
MGR APPR		A Corner Bead	
UNLESS OTHERWISE SPECIFIED DIMENSIONS ARE IN INCHES ANGLES ±X.X°		FILENAME: Corner Bead - Stucco.dwg	
2 PL ±X.XX 3 PL ±X.XXX		SCALE:	WEIGHT: SHEET 1 OF 1