

EIFS EXTERIOR CHANNEL REVEAL

PRODUCT NUMBER	DIMENSION A	DIMENSION B	PIECES PER BOX
2225	1/2"	1/2" MIN.	30
2226	1"	1/2" MIN.	35
2227	3/4"	1/2" MIN.	35
2228	3/8"	1/2" MIN.	30
2229	5/8"	1/2" MIN.	35
2235	1-1/2"	1/2" MIN.	30
2236	2"	1/2" MIN.	30
2237	3"	NO HOLES IN FLANGE	20

10' LENGTHS

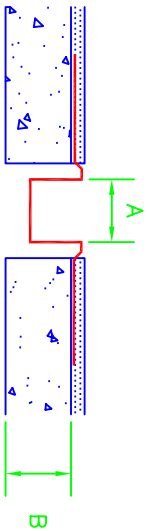
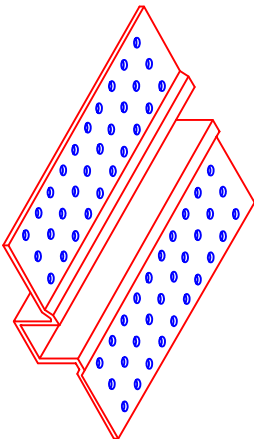

APPLICATION:

MADE FOR EXTERIOR USE IN EIFS SYSTEMS. THE EPS BOARD SHOULD BE ROUTED AND SURFACE MOUNTED REVEAL THEN INSERTED INTO CHANNEL. WIDE PERFORATED SURFACE MOUNTED FLANGES ASSURE POSITIVE BONDING OF BASE COAT TO EPS AND 1/8" STOPS ASSURE PROPER BASE AND FINISH THICKNESS.

SPECIFICATION:

EXTERIOR CHANNEL REVEAL SHALL BE PLASTIC COMPONENTS, INC. # _____ . ALL EXTERIOR ACCESSORIES SHALL CONFORM TO ASTM STANDARDS D1784-97, C1063-99 AND D4216-99 THEY SHALL BE USED WHERE SPECIFIED BY THE ARCHITECT AND INSTALLED PER INDUSTRY STANDARDS AND MANUFACTURER'S INSTRUCTIONS.