

# CI/EIFS/Hard Coat

Section: 07240

## Continuous Soffit Vent

Product Number	For EIFS Applications on 1" and 1-1/2" EPS	Foam Thickness	Pieces per Box
548-1	14 sq. inches free linear air flow (9,033 sq. mm)	1" (25 mm)	10
548-15		1-1/2" (38 mm)	8

10' (3 m) Lengths – Connector clips included

### Application:

Designed for use with 1" and 1-1/2" (25 and 38 mm) foam board. Vent holes 1/8" (3 mm) diameter. Vented area is 2-5/8" (67 mm) wide. Extra wide mounting flanges make attachment to sheathing easier. Wide flange has 1/8" (3 mm) stops with striations to provide positive bond of the base coat and mesh assuring proper finish thickness.

### Specifications:

Continuous Soffit Vent shall be Plastic Components Inc. # \_\_\_\_\_. All exterior accessories shall meet ASTM standards D1784, C1063 and D4216, shall be third party tested and Canadian Code Compliant. They shall be used where specified by the design authority and installed per industry standards.

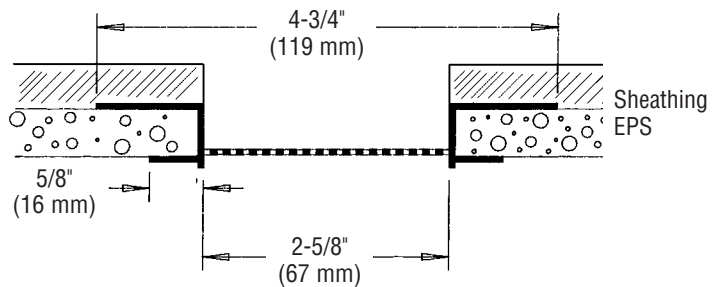

The base coat mesh should be lapped over the top of the perforated flanges and across all butt joints.

