

CI/EIFS/Hard Coat

Section: 07240

Extreme Moisture STARTER TRAC™

Product Number	Description/Dimension A STARTER TRAC™ w/ 3" (76 mm) back flange	Pieces per Box
SB-EMT75	3/4" (19 mm)	30
SB-EMT1	1" (25 mm)	30
SB-EMT15	1-1/2" (38 mm)	30
SB-EMT2	2" (51 mm)	30

10' (3 m) Lengths

Also available in Tan, Gray and Dark Brown contact Customer Service at (800) 327-7077 for more information.

Application:

SB-EMT Starter TRAC is the PVC trim to choose for extreme moisture conditions. For use at the base of a wall, this new Starter TRAC has a 3" (76 mm) back flange and sloped front edge to move moisture out and away from the wall assembly.

Specifications:

Starter TRAC for extreme moisture areas shall be Plastic Components, Inc. #SB-EMT series. All exterior accessories shall meet ASTM standards D1784, C1063 and D4216, shall be third party tested and Canadian Code Compliant. They shall be used where specified by the design authority and installed per industry standards.

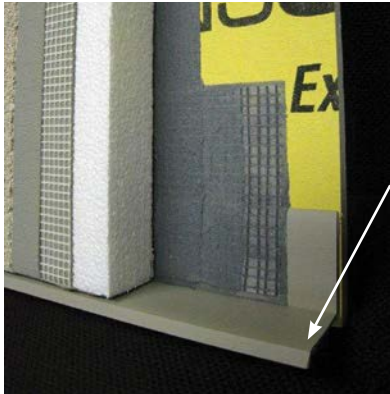
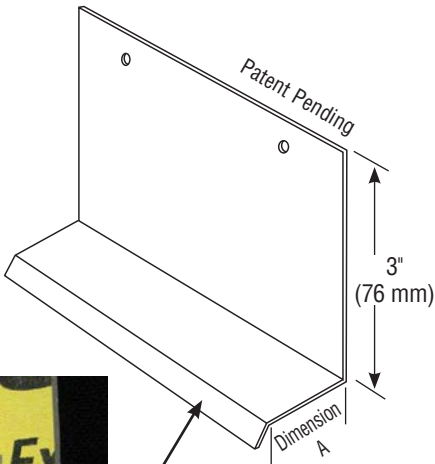

The base coat mesh should be lapped over the top of the perforated flanges and across all butt joints.



305.885.0561 ■ 800.327.7077
www.plasticcomponents.com