

# CI/EIFS/Hard Coat

Section: 07240

## Extreme Moisture STARTER TRAC®

Product Number	Description/Dimension A STARTER TRAC® w/ 3" (76 mm) back flange	Pieces Per Box
SB-EMT75	3/4" (19 mm)	30
SB-EMT1	1" (25 mm)	30
SB-EMT15	1-1/2" (38 mm)	30
SB-EMT2	2" (51 mm)	30

10' (3 m) Lengths

To order with weep slots, add WS to Catalog number i.e. SB-EMT1WS  
 Also available in Tan and Gray, contact Customer Service at (800) 327-7077 for more information.

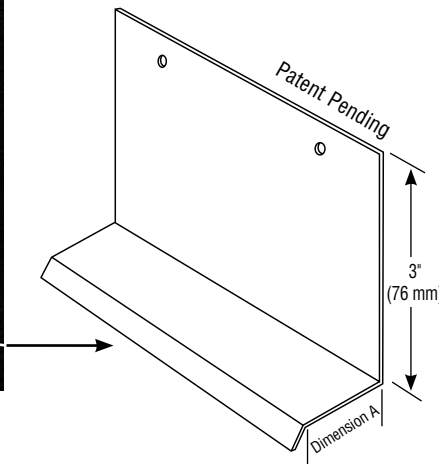
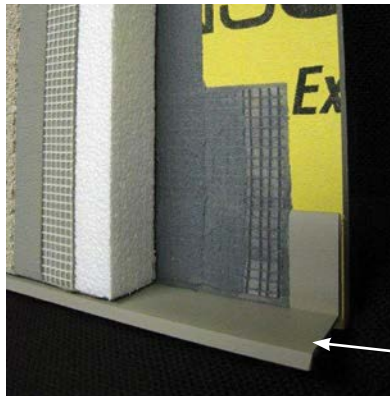

### Application:

Plastic Components' SB-EMT Starter TRAC®, is the PVC trim to choose for extreme moisture conditions. For use at the base of a wall, this new Starter TRAC has a 3" (76 mm) back flange and sloped front edge to move moisture out and away from the wall assembly.

### Specification:

Starter TRAC™ for extreme moisture areas will be Plastic Components, Inc. #\_\_\_\_\_. All exterior accessories shall meet ASTM standards D1784, C1063, C1861 and D4216, shall be third party tested and Canadian Code compliant. They shall be used where specified by the design authority and installed per industry standards.



The base coat mesh should be lapped over the top of the perforated flanges and across all butt joints.

800.327.7077 ■ Fax 305.887.2452  
[www.plasticcomponents.com](http://www.plasticcomponents.com)