

Stucco and Plaster

Section: 09200

Ultra Drain Mat™



| Product Number | Thickness | Description | Roll Dimensions | Coverage | Rolls Per Pallet |
|----------------|--------------|--|-------------------------------|--------------------------------|------------------|
| UDM-25 | .25" (6 mm) | Drainage mat, ventilation system made of durable 2-ply polymer. Fabric backed. | 39" x 61.5' (99 cm x 18.75 m) | 200 sf (18.58 m ²) | 18 |
| UDM-40 | .40" (10 mm) | | 39" x 40' (99 cm x 12.2 m) | 130 sf (12.08 m ²) | 18 |

UDM-40 0.40" (10 mm) product meets the physical requirements of Section 9.27.2.2 Item 1B of the 2005 National Building Code of Canada and 2006 British Columbia Building Code.



.40" (10 mm) Ultra Drain Mat

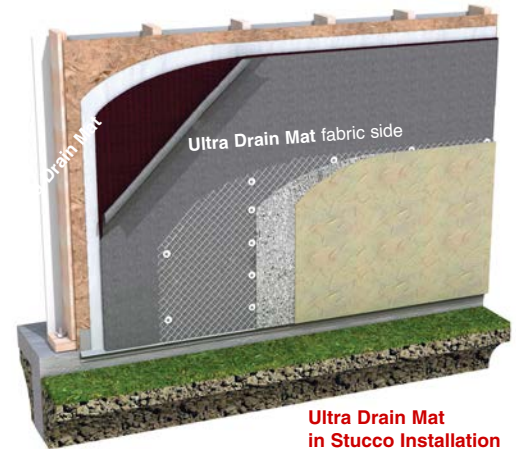

Ultra Drain Mat in Stucco Installation

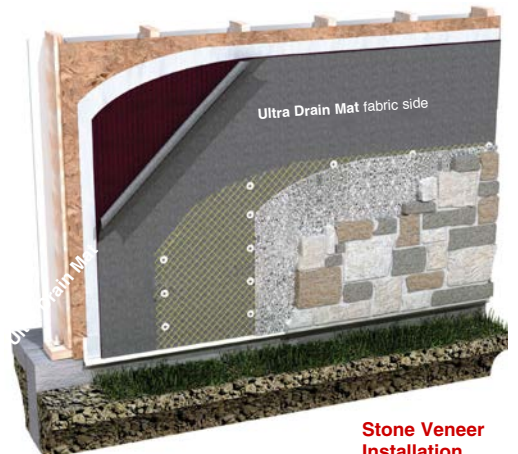

Stone Veneer Installation

Application:

Available in 0.25" (6 mm) and 0.40" (10 mm) thicknesses, Plastic Components' ULTRA DRAIN MAT™ is a drainage and ventilation system specifically designed for use with most exterior cladding systems. Note: 0.40" (10 mm) thickness meets Canadian standards.

Specification:

ULTRA-LATH® Plastic Lath shall be Plastic Components, Inc. # _____. It shall be used where specified by the architect and installed per industry standards ASTM C1764. Meets ASTM 330.84 and ASTM 330.84b.



800.327.7077 ■ Fax 305.887.2452
www.plasticcomponents.com