



Since 1969

PLASTIC *PC*™
COMPONENTS inc.



PVC ACCESSORIES



for Exterior Insulated Finish Systems

Plastic Components

Florida-based **Plastic Components** is the originator and designer of many innovative trims, and since 1969, has manufactured quality plastic trims and accessories for the construction industry that solve problems created by standard metal.



Our nearly 700 line items include corner beads, control joints, vents, slip joints, reveals, and more for continuous insulation and **exterior insulated finish systems (CI/EIFS)**, direct applied (DEFS), stucco, stone veneer and drywall.

From freezing cold to extreme heat, Plastic Components' PVC products deliver optimal results – good looks, easy handling, moisture management, reduced labor costs and superior field performance.

Our trims are tested and listed with Intertek Testing Services/Warnock Hersey to meet or exceed the strict standards set by ASTM.



PVC Trims for Exterior Insulated Finish Systems Save time and improve job quality. They control moisture and make the application of 1/4" or 1/2" stucco easier.

PLASTIC *PC*™
COMPONENTS inc.

Our paintable, UV resistant **PVC Trims for Exterior Insulated Finish Systems** are designed to reduce costs while retaining system integrity. And controlling moisture.

They provide straight and impact-resistant corners, and eliminate labor intensive practices like rasping and backwrapping. Also the need to apply finish at a termination point.



Starter Trac™ Drip Edge

Generic System Detail

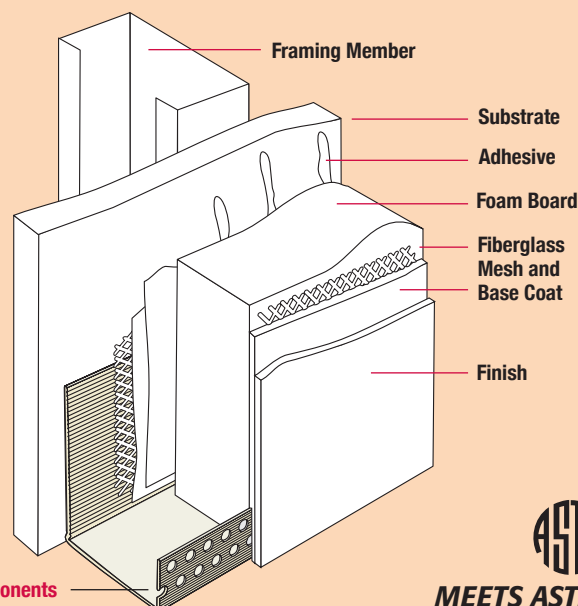

Plastic Components
Starter Trac™ w Weep Holes



MEETS ASTM
D4216, D1784, C1063, C1861

Contact us at **800-327-7077** or **plasticcomponents.com** for assistance.

Manufacturers of PVC Accessories for Stucco/Plaster, CI/EIFS, DEFS & Drywall

Corner Bead · Casing Beads · Drip Trac™

Improve Job Quality · 10 ft (3 m) Lengths · Non-Rusting

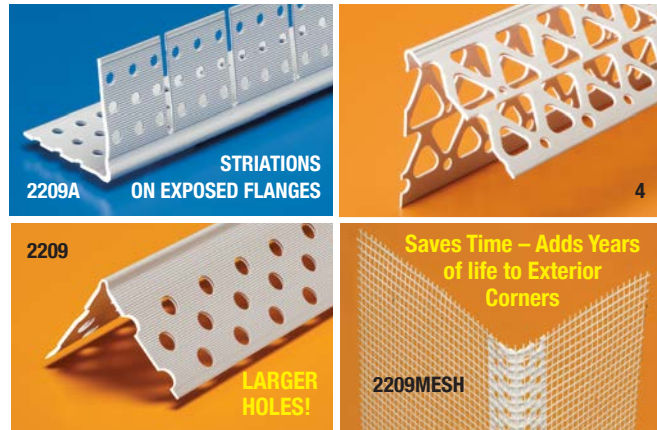

Corner Beads

PRODUCT NUMBER	DESCRIPTION/ DIMENSIONS	PIECES /BOX
2209	Corner Bead with wide, grooved flanges and large holes. 1-5/8" x 1-5/8" (41 mm x 41 mm)	100
4	Corner Bead *also in 8 ft (2.5 m) lengths 2-1/2" x 2-1/2" (64 mm x 64 mm) flanges	50
2209A	Arch Corner Bead the easy way to make arches pre-slotted 1-5/8" (41 mm) flange	100
2209MESH	Mesh Corner Bead *also in 8 ft (2.5 m) lengths w/ 4.5 ounce fire- and alkaline-resistant fiberglass mesh attached to both legs; 3" (76 mm) on one leg, 5" (127 mm) on the other. 7/8" (22 mm) flange. Complies with ASTM D579, EIMA 105.01	50



EIFS Casing Beads Unweeped or weeped

PRODUCT NUMBER	DESCRIPTION/ DIMENSIONS	PIECES /BOX
CB EIFS Casing Bead/Starter Trac™		
CB-50-16	Dimension 'A' – 1/2" (13 mm)	60
CB-58-16	Dimension 'A' – 5/8" (16 mm)	60
CB-75-16	Dimension 'A' – 3/4" (19 mm)	40
CB-1-16	Dimension 'A' – 1" (25 mm)	40
CB-15-16	Dimension 'A' – 1-1/2" (38 mm)	40
CB-2-16	Dimension 'A' – 2" (51 mm)	30
CB-25-16	Dimension 'A' – 2-1/2" (63 mm)	30
CB EIFS Casing Bead with Drip Edge/Starter Trac™		
CB-50-16L	Dimension 'A' – 1/2" (13 mm)	60
CB-58-16L	Dimension 'A' – 5/8" (16 mm)	40
CB-75-16L	Dimension 'A' – 3/4" (19 mm)	40
CB-1-16L	Dimension 'A' – 1" (25 mm)	40
CB-125-16L	Dimension 'A' – 1-1/4" (32 mm)	35
CB-15-16L	Dimension 'A' – 1-1/2" (38 mm)	35
CB-2-16L	Dimension 'A' – 2" (51 mm)	30
CB-25-16L	Dimension 'A' – 2-1/2" (63 mm)	30

10' (3 m) Lengths

Add "WP" to order with Weep Holes.

Example: CBWP-15-16

The base coat mesh should be lapped over the top of the perforated flanges and across all butt joints.

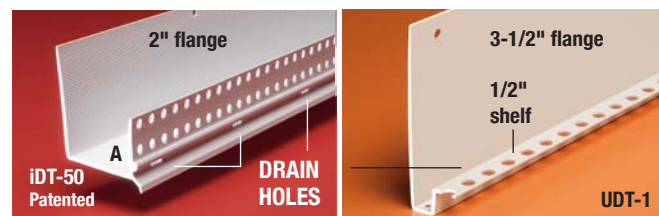

i Drip Trac™ • U-Drip Trac™

PRODUCT NUMBER	DESCRIPTION/ DIMENSIONS	PIECES /BOX
iDT Drip Trac™ with 2" (51 mm) unpunched back flange		
iDT-50	Dimension 'A' – 1/2" (13 mm)	35
iDT-58	Dimension 'A' – 5/8" (16 mm)	35
iDT-75	Dimension 'A' – 3/4" (19 mm)	30
iDT-1	Dimension 'A' – 1" (25 mm)	25
iDT-125	Dimension 'A' – 1-1/4" (31 mm)	20
iDT-15	Dimension 'A' – 1-1/2" (34 mm)	20
iDT-175	Dimension 'A' – 1-3/4" (38 mm)	15
iDT-2	Dimension 'A' – 2" (51 mm)	15
iDT-225	Dimension 'A' – 2-1/4" (57 mm)	15
iDT-25	Dimension 'A' – 2-1/2" (64 mm)	15
iDT-275	Dimension 'A' – 2-3/4" (70 mm)	10
iDT-3	Dimension 'A' – 3" (76 mm)	10
iDT-35	Dimension 'A' – 3-1/2" (89 mm)	10
iDT-4	Dimension 'A' – 4" (102 mm)	10

Measure Dimension 'A' Inside to Inside

U-Drip Trac™ with 3-1/2" (89 mm) unpunched back flange

UDT-1	Heavy-duty. 1/8" (3 mm) weep holes Supports foam board greater than 1" 1/2" (13 mm) shelf w/ 5/16" (8 mm) drainage holes	40
-------	--	----

10' (3 m) Lengths

Heavy Duty

Perfect for EIFS and other foam systems requiring moisture management!

9051 NW 97 Terrace · Miami, Florida 33178 · 305/885-0561 · 800/327-7077 · FAX 305/887-2452

Starter Trac™

Moves Water Out, Away from System • Non-Rusting • 10 ft (3 m) Lengths

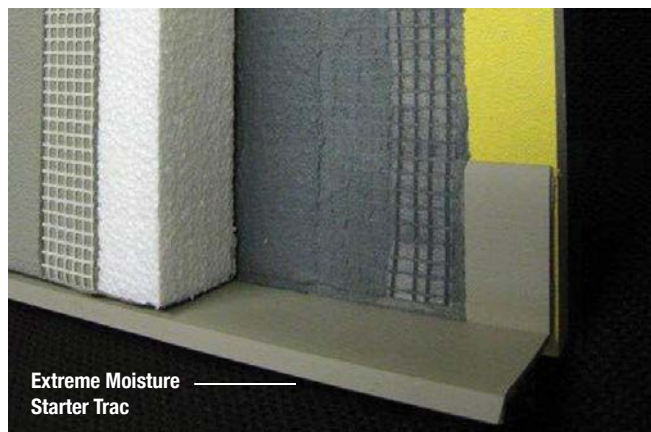

Plastic Components offers a variety of non-rusting Starter Tracs, with and without weep holes, for CI/Exterior Insulated Finish Systems

- Sloped to move moisture away from wall
- Striations and perforations create positive bonding of base to board
- 10' (3 m) Lengths
- Meets ASTM standards D4216, D1784, C1063, C1861

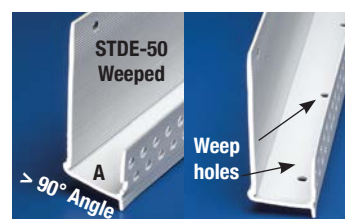
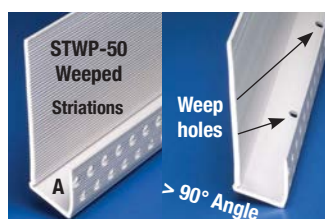
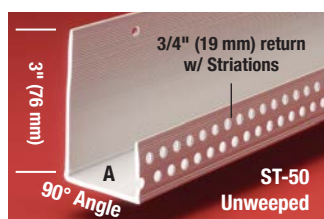

Measure 'A' inside to inside

Starter Trac™ Unweeped

PRODUCT NUMBER	DIM 'A'	PIECES /BOX
ST-50	1/2" (13 mm)	35
ST-58	5/8" (16 mm)	35
ST-75	3/4" (19 mm)	30
ST-78	7/8" (22 mm)	30
ST-1	1" (25 mm)	25
ST-125	1-1/4" (32 mm)	20
ST-15	1-1/2" (38 mm)	20
ST-158	1-5/8" (41 mm)	15
ST-175	1-3/4" (44 mm)	15
ST-2	2" (51 mm)	15
ST-225	2-1/4" (57 mm)	15
ST-25	2-1/2" (64 mm)	15
ST-275	2-3/4" (70 mm)	10
ST-3	3" (76 mm)	10
ST-35	3-1/2" (89 mm)	10
ST-4	4" (102 mm)	10

Starter Trac™ w Weep Holes

PRODUCT NUMBER	DIM 'A'	PIECES /BOX
STWP-50	1/2" (13 mm)	35
STWP-58	5/8" (16 mm)	35
STWP-75	3/4" (19 mm)	30
STWP-78	7/8" (22 mm)	30
STWP-1	1" (25 mm)	25
STWP-125	1-1/4" (32 mm)	20
STWP-15	1-1/2" (38 mm)	20
STWP-158	1-5/8" (41 mm)	15
STWP-175	1-3/4" (44 mm)	15
STWP-2	2" (51 mm)	15
STWP-225	2-1/4" (57 mm)	15
STWP-25	2-1/2" (64 mm)	15
STWP-275	2-3/4" (70 mm)	10
STWP-3	3" (76 mm)	10
STWP-35	3-1/2" (89 mm)	10
STWP-4	4" (102 mm)	10

Use as a Starter Trac or Casing Bead where finished edge is exposed. Features in front return create positive bonding of base to board. 3" (76 mm) nailing flange. *NO drip edge

Splice plates available upon request.

Patented

PLASTIC PC™
COMPONENTS inc.

Starter Trac™ Drip Edge

PRODUCT NUMBER	DIMENSION 'A'	PIECES /BOX	PRODUCT NUMBER	DIMENSION 'A'	PIECES /BOX
STDE-50	1/2" (13 mm)	35	STDE-175	1-3/4" (44 mm)	15
STDE-58	5/8" (16 mm)	35	STDE-2	2" (51 mm)	15
STDE-75	3/4" (19 mm)	30	STDE-225	2-1/4" (57 mm)	15
STDE-78	7/8" (22 mm)	30	STDE-25	2-1/2" (64 mm)	15
STDE-1	1" (25 mm)	25	STDE-275	2-3/4" (70 mm)	10
STDE-125	1-1/4" (32 mm)	20	STDE-3	3" (76 mm)	10
STDE-15	1-1/2" (38 mm)	20	STDE-35	3-1/2" (89 mm)	10
STDE-4	4" (102 mm)	10			

Striations, perforations on front return ensure positive bonding of base coat to board. 3" (76 mm) nailing flange. > 90° base shelf has weep holes spaced 3" (76 mm) o.c. to allow water to migrate from the system.

Splice plates available upon request.

Patented

Extreme Moisture Starter Trac™

PRODUCT NUMBER	DIMENSION 'A'	DESCRIPTION	PIECES /BOX
SB-EMT75	3/4" (19 mm)		30
SB-EMT1	1" (25 mm)	3" (76 mm) back flange	30
SB-EMT15	1-1/2" (38 mm)		30
SB-EMT2	2" (51 mm)		30
End Caps for Extreme Starter Trac			
WDEC3-1	3" (76 mm)	1" (25 mm)	30
WDEC3-15	back flange	1-1/2" (38 mm)	30
WDEC3-2		2" (51 mm)	
		BOTTOM FLANGE	SETS/BOX

The base coat mesh should be lapped over the top of the perforated flanges and across all butt joints.



Manufacturers of PVC Accessories for Stucco/Plaster, CI/EIFS, DEFS & Drywall

One-Piece Continuous Insulation Trims

for use with 3/4" and 7/8" Stucco Finishes

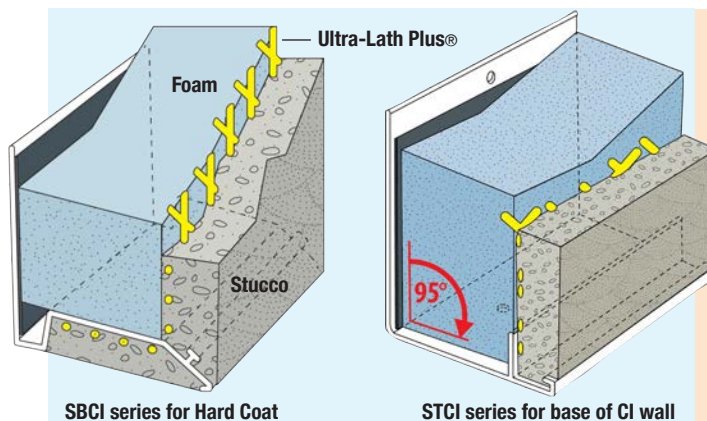

Our CI Trims combine a weeped Starter Trac™ and bead into a *single piece*, saving time – and improving job quality

- **Two styles** SBCI series for Hard Coat; STCI series for base of three-coat stucco CI wall
- Drain holes move moisture away from wall
- 10' (3 m) Lengths
- Meets ASTM standards D4216, D1784, C1063, C1861

Patent pending

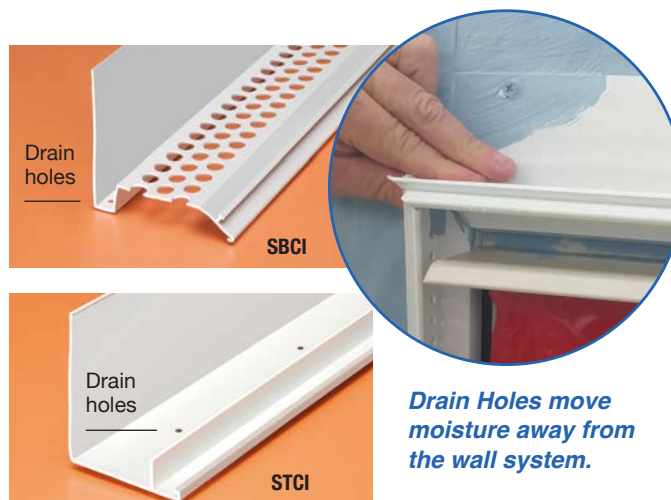

One-piece Hard Coat Trac™

Combines a weeped foam Trac™ and corner bead in one piece

PRODUCT NUMBER	FOAM THICKNESS	STUCCO GROUND	PIECES /BOX
SBCI-15-75	1-1/2" (38 mm)	for 3/4" (19 mm)	8
SBCI-2-75	2" (51 mm)	STUCCO	8
SBCI-25-75	2-1/2" (64 mm)	FINISH	8
SBCI-15-78	1-1/2" (38 mm)	for 7/8" (22 mm)	8
SBCI-2-78	2" (51 mm)	STUCCO	8
SBCI-25-78	2-1/2" (64 mm)	FINISH	8

One-piece Hard Coat Trac™ for Base of CI Wall

Combines a weeped Starter Trac™ and termination bead into a single, one-piece trim piece

PRODUCT NUMBER	FOAM THICKNESS	STUCCO GROUND	PIECES /BOX
STCI-15-75	1-1/2" (38 mm)	for 3/4" (19 mm)	8
STCI-2-75	2" (51 mm)	STUCCO	8
STCI-25-75	2-1/2" (64 mm)	FINISH	8
STCI-15-78	1-1/2" (38 mm)	for 7/8" (22 mm)	8
STCI-2-78	2" (51 mm)	STUCCO	8
STCI-25-78	2-1/2" (64 mm)	FINISH	8

2-piece Hard Coat EIFS Casing Bead/Starter Trac™ with 2" (51 mm) back flange

PRODUCT NUMBER	FOAM DIMENSION 'A'	GROUND DIMENSION 'B'	PIECES /BOX
SC-1-15		1/8" (3 mm)	50
SC-1-25	1"	1/4" (6 mm)	50
SC-1-38	(25 mm)	3/8" (10 mm)	50
SC-1-50		1/2" (13 mm)	50
SC-15-25		1/4" (6 mm)	40
SC-15-38	1-1/2" (38 mm)	3/8" (10 mm)	40
SC-15-50		1/2" (13 mm)	40
SC-2-25		1/4" (6 mm)	30
SC-2-38	2" (51 mm)	3/8" (10 mm)	30
SC-2-50		1/2" (13 mm)	30

Add 'WP' to order with weep holes. Example: SCWP-1-15

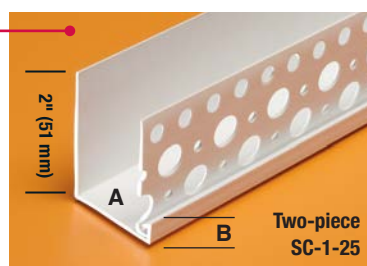

The base coat mesh should be lapped over the top of the perforated flanges and across all butt joints.

9051 NW 97 Terrace • Miami, Florida 33178 • 305/885-0561 • 800/327-7077 • FAX 305/887-2452

Aesthetic Reveals & Intersections

Paintable • UV Resistant • Non-Rusting • 10 ft (3 m) Lengths



The easy way to create attractive architectural details in Exterior Insulated Finish Systems

- Multiple reveal dimensions with matching intersections that deliver aesthetically pleasing details
- 10' (3 m) Lengths
- Meets ASTM standards D4216, D1784, C1063, C1861

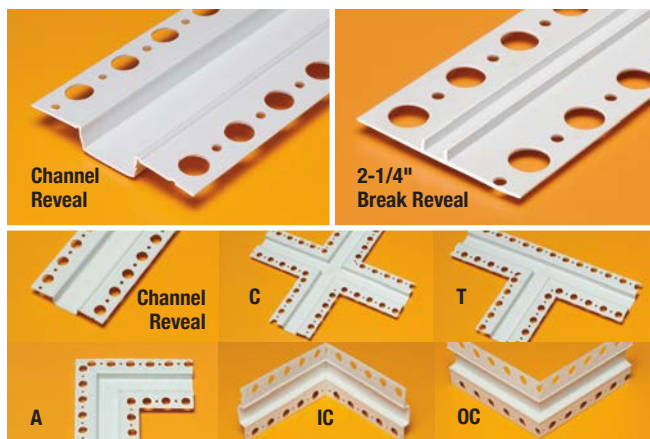

EIFS Exterior Aesthetic Channel Reveal

For 1/2" (13 mm) or 5/8" (16 mm) Sheathing Applications

PRODUCT NUMBER	REVEAL WIDTH	ADDITIONAL PRODUCT DETAIL	PIECES /BOX
2225	1/2" (13 mm)		30
2226	1" (25 mm)		35
2227	3/4" (19 mm)		35
2228	3/8" (10 mm)		30
2229	5/8" (16 mm)		35
2235	1-1/2" (38 mm)	Large and small holes on flange	30
2236	2" (51 mm)	Large and small holes on flange	30
2237	3" (76 mm)	Unpunched flange	20
2239	4" (102 mm)	Unpunched flange	20

'F' Series also available. Call Customer Service, 800.327.7077

Break Reveal

PRODUCT NUMBER	OVERALL WIDTH	DIMENSIONS/ PRODUCT DETAIL	PIECES /BOX
1552	2-1/4" flange (57 mm)	1/4" reveal width x 1/8" ground (6 mm x 3 mm)	50
1553	2-1/4" flange (57 mm)	1/2" reveal width x 1/8" ground (13 mm x 3 mm)	50
1554	2-1/4" flange (57 mm)	3/4" reveal width x 1/8" ground (19 mm x 3 mm)	50
1556	Wide flange 5-1/8" (130 mm)	3/8" reveal width x 1/8" ground (10 mm x 3 mm) Break reveal used in tilt wall market to cover joints.	35

EIFS Reveal Intersections

PRODUCT NUMBER	REVEAL WIDTH	DEPTH 1/2" (13 mm) PRODUCT DETAIL	PIECES /BOX
2225	1/2" (13 mm)	To order, add product suffix. C = Cross T = T A = Angle EC = End Closure OC = Outside Corner IC = Inside Corner Examples: 2225IC (Inside Corner), 2225C (Cross), 2225A (Angle), etc	25
2226	1" (25 mm)		25
2227	3/4" (19 mm)		25
2228	3/8" (10 mm)		25
2229	5/8" (16 mm)		25
2235	1-1/2" (38 mm)		25
2236	2" (51 mm)		25
2237	3" (76 mm)		25
2239	4" (102 mm)		25

PLASTIC PCTM
COMPONENTS inc.

Manufacturers of PVC Accessories for Stucco/Plaster, CI/EIFS, DEFS & Drywall



The base coat mesh should be lapped over the top of the perforated flanges and across all butt joints.

Angle Termination Bead · 'Z' Flashing

Control Joints · Vents Paintable · 10 ft (3 m) Lengths · No Rust



Save on Labor. Paintable. Better Job Quality!

Termination Bead for sealant backing...

'Z' Flashing reduces thermal bridging in CI projects...

Control Joints solve problems caused by expansion and contraction... **Soffit Vents** in many styles, with choice of vent widths

- 10' (3 m) Lengths
- Meets ASTM standards
D4216, D1784, C1063, C1861



45° Angle
2221-45

STRIATIONS
ON EXPOSED
FLANGES



'Z' Flashing
SBZ1-3-1

45° Angle Termination Bead

PRODUCT NUMBER	DIMENSION/ DESCRIPTION	PIECES /BOX
2221-45	45° angled bead for use as a backing for sealant around any opening	100

Heavy Duty 'Z' Flashing Reduces thermal bridging in CI

PRODUCT NUMBER	DIMENSION/ DESCRIPTION	Nominal thickness 1/8" (3 mm)	PIECES /BOX
SBZ1-1-1	1" x 2" x 1" (25 mm x 51 mm x 25 mm)		20
SBZ1-2.5-1	1" x 2-1/2" x 1" (25 mm x 64 mm x 25 mm)		20
SBZ1-3-1	1" x 3" x 1" (25 mm x 76 mm x 25 mm)		20
SBZ1-4-1	1" x 4" x 1" (25 mm x 102 mm x 25 mm)		15



Control Joints

22027-16



2138XS

PRODUCT NUMBER	DESCRIPTION	PIECES /BOX
EIFS 'V' Control Joint		
22027-16	1/16" (2 mm)	50
22027-25	1/4" (6 mm)	35
22027-38	3/8" (10 mm)	25
EIFS 'M' Control Joint Surface Mount		
2138XS	for 3/8" (10 mm) thick finish. Removable tape.	50



Surface
Mounted Vent



Continuous
Soffit Vent

Soffit Vents Connector clips included

PRODUCT NUMBER	DESCRIPTION	FREE AIR FLOW PER LINEAR FT	PIECES /BOX
Surface Mounted Vent			
3" • 4" • 6" wide vents			
SMV3	Vent area 3" (76 mm)	15 sq. inches (9,678 sq. mm)	35
SMV4	Vent area 4" (102 mm)	16 sq. inches (10,323 sq. mm)	35
SMV6	Vent area 6" (152 mm)	20 sq. inches (12,904 sq. mm)	30
Continuous Soffit Vent			
for applications on 1", 1-1/2" EPS			
548-1	for 1" (25 mm) foam	14 sq. inches (9,033 sq. mm)	10
548-15	for 1-1/2" (38 mm) foam	16 sq. inches (10,323 sq. mm)	8
2-piece Soffit Vent			
with 90° Leg that installs facing up or down			
FS548-1 WF551			
for 1" (25 mm) board		Vent area 2-5/8" (67 mm)	10
FS548-15 WF551			
for 1-1/2" (38 mm) board		14 sq. inches (9,033 sq. mm)	8

Superior air flow

Prevent heat and moisture buildup in attics with PVC soffit vents



2-piece
Soffit Vent

The base coat mesh should be lapped over the top of the perforated flanges and across all butt joints.

9051 NW 97 Terrace • Miami, Florida 33178 • 305/885-0561 • 800/327-7077 • FAX 305/887-2452

Window/Door Drip Edge, End Caps

2" Back Flange · 10 ft (3 m) Lengths · Non-Rusting



Ideal for moisture control in exterior window and door openings

- 90° angle shelf moves water away from openings around window/door frame
- 10' (3 m) Lengths
- Meets ASTM standards D4216, D1784, C1861, C1063, C926

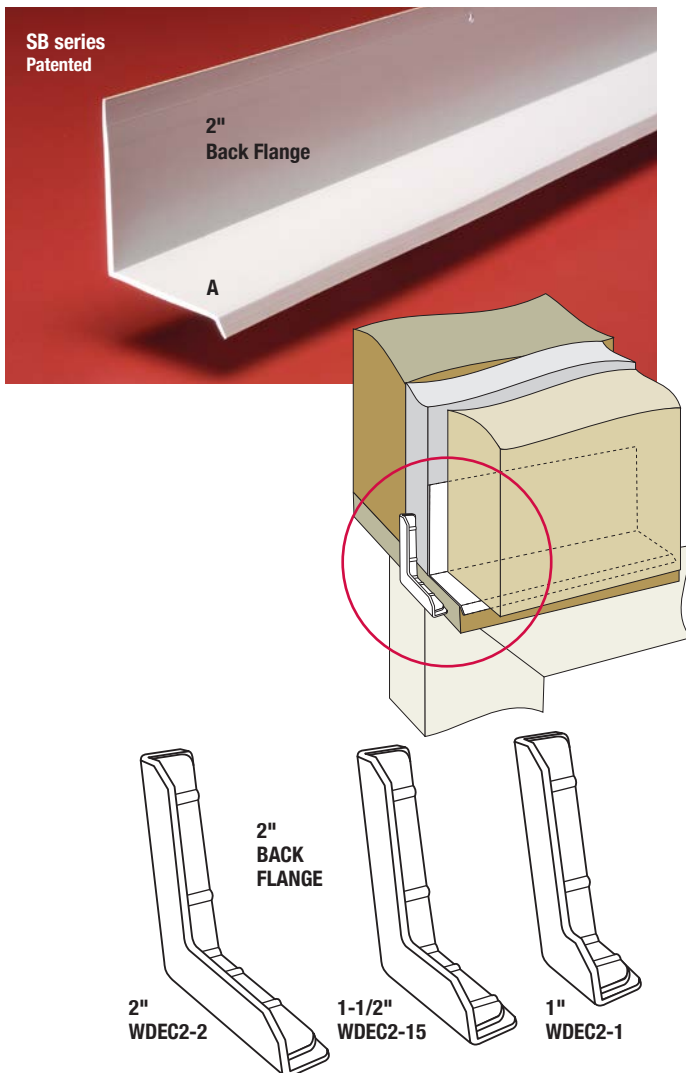

Window/Door Drip Edge

PRODUCT NUMBER	DESCRIPTION/DIMENSIONS	DIMENSION 'A'	PIECES /BOX
SB-50		1/2" (13 mm)	100
SB-58		5/8" (16 mm)	100
SB-75	2" (51 mm)	3/4" (19 mm)	100
SB-78	Back Flange	7/8" (22 mm)	75
SB-1		1" (25 mm)	75
SB-15	< 90° angle	1-1/2" (38 mm)	60
SB-2	Bottom Flange	2" (51 mm)	50
SB-25		2-1/2" (64 mm)	30
SB-3		3" (76 mm)	30
SB-4		4" (102 mm)	25
SB-1-25X	for 1/4" (6 mm) stucco finishes		70

End Caps for SB series Window/Door Drip Edge

PRODUCT NUMBER	BACK FLANGE	BOTTOM FLANGE	SETS /BOX
WDEC2-1	2" (51 mm)	1" (25 mm)	25
WDEC2-15	2" (51 mm)	1-1/2" (38 mm)	25
WDEC2-2	2" (51 mm)	2" (51 mm)	25

Patented



The base coat mesh should be lapped over the top of the perforated flanges and across all butt joints.

9051 NW 97 Terrace · Miami, Florida 33178 · 305/885-0561 · 800/327-7077 · FAX 305/887-2452

www.plasticcomponents.com · orders@plasticcomponents.com

Arched Window/Door Drip Edge, End Caps

3-1/2" Back Flange · 10 ft (3 m) Lengths · Non-Rusting



Control moisture in arched or curved exterior window and door openings

- Make arches the easy way with WDA series window/door drip edge
- 10' (3 m) Lengths
- Meets ASTM standards D4216, D1784, C1861, C1063, C926

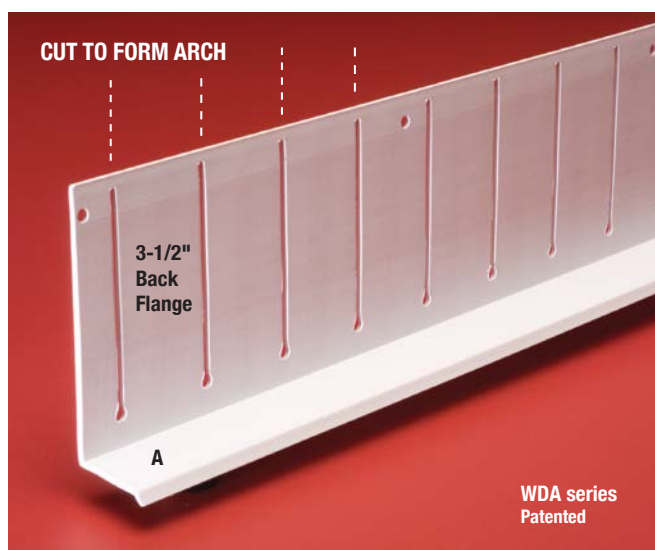

WDA Arched Window/Door Drip Edge

PRODUCT NUMBER	DESCRIPTION/ DIMENSIONS	DIMENSION 'A'	PIECES /BOX
WDA-75		3/4" (19 mm)	30
WDA-1	3-1/2" (89 mm)	1" (25 mm)	30
WDA-1125	Back Flange	1-1/8" (29 mm)	30
WDA-15		1-1/2" (38 mm)	30
WDA-175	Pre-punched for cutting	1-3/4" (45 mm)	30
WDA-2		2" (51 mm)	30
WDA-25		2-1/2" (64 mm)	30

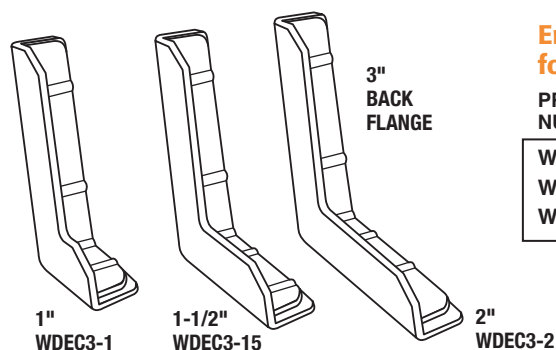

End Caps for WDA series Arched Window/Door Drip Edge

PRODUCT NUMBER	BACK FLANGE	BOTTOM FLANGE	SETS /BOX
WDEC3-1	3" (76 mm)	1" (25 mm)	25
WDEC3-15	3" (76 mm)	1-1/2" (38 mm)	25
WDEC3-2	3" (76 mm)	2" (51 mm)	25

Patented

The base coat mesh should be lapped over the top of the perforated flanges and across all butt joints.

9051 NW 97 Terrace · Miami, Florida 33178 · 305/885-0561 · 800/327-7077 · FAX 305/887-2452

www.plasticcomponents.com · orders@plasticcomponents.com

Trims for Exterior Insulated Finish Systems

Non-Rusting Moisture Control • 10 ft (3 m) Lengths

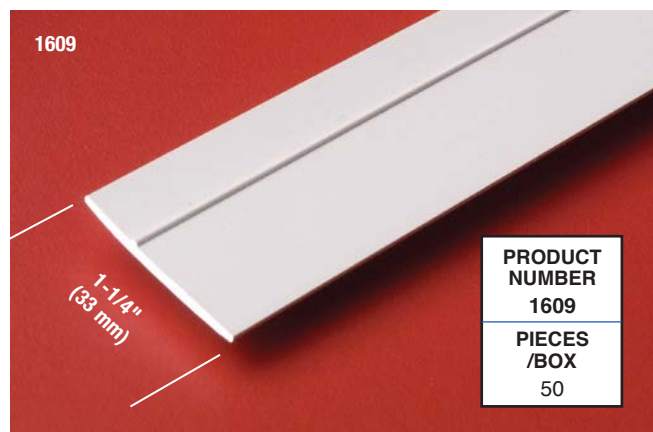

Raised Bridge Joint

Here's a time-saving alternative to removing foam from around a window, and then installing backer rod and caulk.

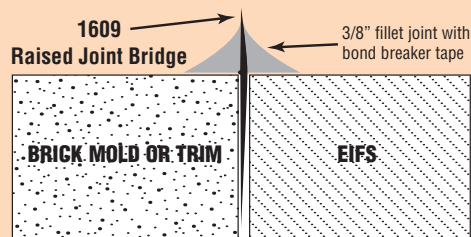

Casing Bead/Starter Trac™

PRODUCT NUMBER	DIMENSION/ DESCRIPTION	PIECES /BOX
SX-187-16	Reinforced Casing Bead with 1-5/8" (41 mm) perforated flange and 3/16" (5 mm) lip	75

IN BOX™

Low Profile, Recessed Electrical Box
for DEFS and EIFS wall systems

PRODUCT NUMBER	FOR DEFS & EIFS WALL SYSTEMS	FLANGE STYLE	COVER COLOR	PIECES /BOX
PCDBVME1C	for 1-1/2" (38 mm)	Fixed	Clear	4
PCDBVME1W	for 1-1/2" (38 mm)	Fixed	White	4
PCDBVMA1C	for systems up to 2" (51 mm) thick	Adjustable	Clear	4
PCDBVMA1W	for systems up to 2" (51 mm) thick	Adjustable	White	4

PCDBVMA1W

PCDBVME1W

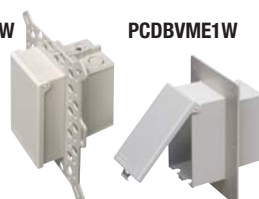

PLASTIC PC™
COMPONENTS inc.



Sill Wedge for positive slope at window sill

PRODUCT NUMBER	SILL WEDGE WIDTH	DESCRIPTION/ PRODUCT DETAIL	PIECES /BOX
SW-3-78	3" (76 mm)	Window frame sits on 1/4" sloped sill wedge. Moisture drains out at the bottom of system	30
SW-5-78	5" (127 mm)		30

Vent Screen Trac™

PRODUCT NUMBER	BOARD THICKNESS	DIMENSIONS/ PRODUCT DETAIL	PIECES /BOX
VST-50	1/2" (13 mm)	Trac for EIFS systems with double row of drainage holes on back flange.	35
VST-58	5/8" (16 mm)	1-1/8" (29 mm) return face flange. 4-hole pattern for superior bond of base coat to board. 2" (51 mm) nailing flange with nail holes set at 4" (102 mm) o.c.	35

Manufacturers of PVC Accessories for Stucco/Plaster, CI/EIFS, DEFS & Drywall

9051 NW 97 Terrace • Miami, Florida 33178

305/885-0561 • FAX 305/887-2452

800/327-7077

www.plasticcomponents.com • orders@plasticcomponents.com

EIFS_1223
1M

©2023 Plastic Components, Inc.